

HARBINGER OF SPRING

A DAFFODIL SHOW

sponsored by

The ADENA DAFFODIL SOCIETY

in cooperation with the

VETERANS ADMINISTRATION  
MEDICAL CENTER

Building 9, Recreation Hall  
Chillicothe, Ohio

Thursday, April 14, 1983

Veterans Administration  
Medical Center

Entries Received 8 to 11 a.m.,  
April 14

Judging beginning 12 noon

Open to the Public,  
2 to 5 p.m., Thursday

APPROVED BY AMERICAN  
DAFFODIL SOCIETY

Admission Free

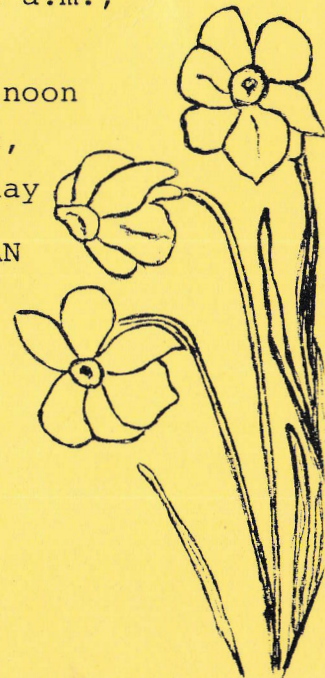

Mrs. Howard Jenks  
1270 Quaker Rd.  
Washington C. H., OH 43160



Mrs. Marilyn Howe  
11831 Junietta  
Culver City, California 90230

Daffodil Show presented by

ADENA DAFFODIL SOCIETY

Show Chairman:

Betty Beery  
2604 Norman Hill Road  
Frankfort, OH 45628  
Phone: (614) 998-5334

President:

Ruth Junk  
1270 Austin Road  
Washington CH, OH 43160  
Phone: (614) 998-5349

Handy Hatfield  
22799 Ringgold Southern Road  
Stoutsville, OH 43154

in cooperation with

Veterans Administration Medical Center

Garlond E. Evers, Director

Richard J. Stanley, Associate Director

Joseph E. Rouleau, Chief, Voluntary Service

David Leedom, Chief, Vocational Rehabilitation Therapy

Bill Goff, Greenhouse Supervisor

with Workshop by

PICKAWAY COUNTY GARDEN CLUB

Mrs. Frank Gans  
506 Dunkel Road  
Circleville, OH 43113

## RULES FOR EXHIBITORS

1. Classes are open to all ADS members and amateur exhibitors except as stated in the schedule.
2. Daffodils in the Horticulture section will be classified according to the Royal Horticultural Society System of Classification as printed in the latest edition of Daffodils to Show and Grow and the ADS Data Print-Out.
3. Exhibitors may make as many entries as he wishes in any class of Horticulture, provided each entry is a different cultivar of species or any entirely different collection of cultivars and/or species. One entry only is permitted in each Artistic class.
4. All blooms in the Horticulture section must have been grown in open by the exhibitor. Miniatures may be grown in protected areas.
5. Containers and evergreen clippings will be provided for specimens. Entry tags will be furnished.
6. Entries which are not named or are incorrectly named will not be judged. However, the originator or other persons may show blooms of standard seedlings in classes for named cultivars. Blooms of seedlings (candidates for the Miniature List) may be shown in classes with those Miniatures named in the most recent ADS Approved List. All seedlings must be identified by a number designation assigned by the originator. If the exhibitor is not the originator, the name of the originator must be included as part of the identification. Entries which are not named will not be judged.
7. Each stem in an exhibit receiving an ADS award must score 90% or more by the ADS scale of points.
8. All collections of five or more stems must be exhibited with each cultivar or species in a separate container. Each cultivar or species must be correctly and individually labeled. List all cultivars on entry tag.

9. Miniature daffodils, as named in the most recent ADS Approved List of Miniatures, may be shown only in classes for miniatures and seedlings (candidates for the miniature list).
10. Only one first, one second, and one third award may be given in each class. Honorable Mention Awards may also be given.
11. Any and all awards may be withheld by the judges if in their opinion the exhibit is not worthy. The decision of the judges shall be final, except as stated in Rule 12.
12. Correct classification and labeling shall be the responsibility of the exhibitor. Color Code letters are required on entry tags. No label may be changed, specimen added, removed or substituted after judging has begun or after awards have been placed. If an error is discovered in an exhibit after completion of judging, any award placed thereon (ADS, special or ribbon) shall be forfeited by the exhibitor.
13. A worthy specimen from a vase of three of one cultivar and/or species or from a collection which did not win a blue ribbon (or any ribbon) may be considered for the best standard bloom in the show. The same principle applies to selection of the best miniature daffodil in the show.
14. The Show Committee, prior to judging, will set up subclasses if the number of entries warrants.

## DESIGN RULES

1. Artistic Design entries must be arranged by the exhibitor.
2. Containers and accessories are entered at owners risk and should be clearly marked with name and address.

3. Artistic Design classes must include some daffodils (two or more) in an arrangement.
4. Fresh plant material must be included in each arrangement. Plant material may be obtained from any source for arrangements. No artificial plant material is allowed. Painted, treated, tinted or dried plant material may be used, but no painted fresh plant material.
5. An exhibitor may make only one entry in each class.
6. Entries may not be removed before 4 p.m., Thursday, April 14, 1982.

#### ADS SCALE OF POINTS

Condition . . . . .	20
Form . . . . .	20
Substance and Texture . . . . .	15
Color . . . . .	15
Pose . . . . .	10
Stem . . . . .	10
Size . . . . .	<u>10</u>
	100

For vases of three of one cultivar and/or species, judges may deduct up to 5 points for lack of uniformity.

For miniatures, the judges will consider "grace" under "form".

#### HORTICULTURE DIVISION

Royal Horticultural Society System of Classification.  
Color Coding Authority: Daffodils to Show and Grow and ADS Data Print-Out.

Color Code Letters required on all entries.

SECTION A - Single specimens

SECTION B - Vase of 3 stems, one cultivar or species

SECTION C - Five different cultivars or species  
stem each, correctly and individually  
labeled.

	<u>SECTION</u>		
	<u>A</u>	<u>B</u>	<u>C</u>
	<u>Class</u>	<u>Class</u>	<u>Class</u>
<u>DIVISION 1 - TRUMPET DAFFODILS</u>			109
Deep yellow perianth, deep yellow trumpet	1	55	
Pale yellow perianth, pale yellow or pink trumpet	2	56	
Colored perianth, orange or red trumpet	3	57	
Colored perianth, trumpet paler	4	58	
White perianth, yellow trumpet	5	59	
White perianth, orange or red trumpet	6	60	
White perianth, pink in trumpet	7	61	
White perianth, white trumpet	8	62	
<u>DIVISION 2 - LONG CUPPED DAFFODILS</u>			110
Yellow perianth, cup yellow	9	63	
Yellow or orange perianth, cup predominantly* orange or red	10	64	
Yellow perianth, cup rimmed orange or red	11	65	
Yellow perianth, cup pink	12	66	
Colored perianth, cup paler	13	67	
White perianth, cup yellow or rimmed yellow	14	68	
White perianth, cup predominantly* orange or red	15	69	
White perianth, cup rimmed orange or red	16	70	
White perianth, cup predominantly* pink	17	71	
White perianth, cup rimmed pink	18	72	
White perianth, cup white	19	73	

\*Predominant means color in at least 2 cup zones for purposes of this schedule.

	SECTION		
	A	B	C
	Class	Class	Class
<u>DIVISION 3 - SHORT CUPPED DAFFODILS</u>			111
Yellow perianth, cup yellow	20	74	
Yellow or orange perianth, cup			
predominantly* orange or red	21	75	
Yellow perianth, cup rimmed orange or red	22	76	
Colored perianth, cup paler	23	77	
White perianth, cup yellow or rimmed			
yellow	24	78	
White perianth, cup predominantly* orange			
or red	25	79	
White perianth, cup rimmed orange or red	26	80	
White perianth, pink in cup	27	81	
White perianth, cup white	28	82	
<u>DIVISION 4 - DOUBLE DAFFODILS</u>			112
Yellow perianth, one bloom to stem	29	83	
White perianth, one bloom to stem	30	84	
Any color, two or more blooms to stem	31	85	
<u>DIVISION 5 - TRIANDRUS DAFFODILS</u>			113
Yellow perianth, cup yellow or orange	32	86	
Colored perianth, cup paler	33	87	
White perianth, cup yellow or pink	34	88	
White perianth, cup white	35	89	
<u>DIVISION 6 - CYCLAMINEUS DAFFODILS</u>			114
Yellow perianth, cup yellow	36	90	
Yellow perianth, orange or red in cup	37	91	
Colored perianth, cup paler	38	92	
White perianth, cup yellow	39	93	
White perianth, pink in cup	40	94	
White perianth, cup white	41	95	
<u>DIVISION 7 - JONQUILLA DAFFODILS</u>			115
Yellow perianth, cup yellow	42	96	
Yellow or orange perianth, orange or			
red in cup	43	97	
Colored perianth, cup paler	44	98	
White perianth, cup yellow or pink	45	99	
White perianth, cup white	46	100	

	SECTION		
	A	B	C
	Class	Class	Class
<u>DIVISION 8 - TAZETTA DAFFODILS</u>			116
Yellow perianth, cup any color	47	101	
White perianth, cup any color	48	102	
<u>DIVISION 9 - POETICUS DAFFODILS</u>			117
White perianth, green eye in cup	49	103	
White perianth, any other color eye	50	104	
<u>DIVISION 10 - SPECIES AND WILD FORMS</u>			118
<u>AND THEIR HYBRIDS</u>	51	105	
<u>DIVISION 11 - SPLIT CORONA DAFFODILS</u>			119
White perianth, corona any color	52	106	
Yellow perianth, corona any color	53	107	
<u>DIVISION 12 - MISCELLANEOUS DAFFODILS</u>	54	108	120

#### SECTION D - SPECIAL COLLECTIONS

One stem each from any division or divisions individually labeled.

Class 121 - Colored perianth, corona paler than perianth - 5 cultivars.

Class 122 - Daffodils of American breeding or origin, 5 cultivars labeled with originators name

Class 123 - 12 cultivars and/or species representing not less than 4 divisions.

## MINIATURES

SECTION E - Single stem, any division

SECTION F - Three stems of one cultivar or species, any division

	SECTION	
	E	F
	Class	Class
DIVISION 1 - Trumpet Daffodils	124	134
DIVISION 2 - Long Cupped Daffodils	125	135
DIVISION 3 - Short Cupped Daffodils	126	136
DIVISION 4 - Double Daffodils	127	137
DIVISION 5 - Triandrus Daffodils	128	138
DIVISION 6 - Cyclamineus Daffodils	129	139
DIVISION 7 - Jonquilla Hybrids	130	140
DIVISION 8 - Tazetta Hybrids	131	141
DIVISION 10- Species and Wild Forms and their Hybrids	132	142
DIVISION 12- Miscellaneous Daffodils	133	143

SECTION G - ADS LAVENDAR RIBBON

Class 144 - Collection of 5 Miniature cultivars and/or species, one stem each from any division or divisions.

SECTION H - SEEDLINGS

Seedlings grown and exhibited by the originator only, with his designated number, classification and parentage (if known) NOTE: The originator of a daffodil seedling is the person who first flowers the bulb, regardless of who made the cross or who planted the seed.

Class 145 - One stem, standard cultivar, eligible for ADS Rose Ribbon.

Class 146 - One stem, candidate for Miniature list, eligible for ADS Miniature Rose Ribbon.

## SECTION I - ADS AWARDS OPEN ONLY TO ADS MEMBERS

Class 147 - ROBERTA C. WATROUS AWARD

Silver Medal or Ribbon, for a collection of twelve cultivars and/or species of miniature daffodils, one stem each, from at least three divisions.

This medal may be won only once by an exhibitor. A former winner may exhibit in this class but will receive the Watrous Ribbon only.

Class 148 - CAREY E. QUINN AWARD

Silver Medal or Ribbon, for a collection of 24 cultivars and/or species of standard daffodils from at least five different divisions, of one stem each.

This medal may be won only once by an exhibitor. A former winner may exhibit in this class but will receive the Quinn Ribbon only.

Class 149 - THROCKMORTON RIBBON AWARD

Dr. Tom D. Throckmorton collection of 15 standard cultivars: one stem each from fifteen different RHS classification, each labeled with name, color code, and classification. OPEN TO ALL

## ADENA DAFFODIL SOCIETY AWARDS

Ruth Pardue Trophy - Best standard daffodil (rotating).

Mary Elizabeth Blue Founder's Trophy - Best collection of five from any class 109 - 120.

*Panel 3*  
Best Artistic Design - Section J - Blue Rosette

*Panel 3*  
Best Artistic Design - Section K - Blue Rosette

Cornelia Vanmeter Metzger Memorial Award (rotating) - best artistic design by Adena Daffodil Society member in Section J.

*Panel 1-2-3*  
Adena Daffodil Society Award - best standard American bred daffodil.

THEME

Harbinger of Spring

SECTION J

ADS members and amateur exhibitors may enter. Each entry in the artistic design division must include two or more daffodils.

Class 150 - The Buds are Swelling. Arrangement using branches, forced or bare.

Class 151 - Spring Rains. Arrangement with water showing.

Class 152 - Never Leave a Stone Unturned. Arrangement using stone or stones.

Class 153 - Springs Precious Gems are in Bloom. Arrangement using weathered wood.

SECTION K - VETERANS DAY

Class 154 - The Buds are Swelling. Arrangement using branches, forced or bare.

Class 155 - Spring Rains. Arrangement with water showing.

Class 156 - Never Leave a Stone Unturned. Arrangement using stone or stones.

Class 157 - Springs Precious Gems are in Bloom. Arrangement using weathered wood.

SECTION L - EDUCATIONAL EXHIBITS

Daffodil Catalog

ADS Journals

Summary of Daffodil Classifications

Development of Daffodil Bulb

AMERICAN DAFFODIL SOCIETY AWARDS

*Panel 1-2-3*

Gold Ribbon - Best standard daffodil in Horticulture

*Panel-3*

Miniature Gold Ribbon - Best miniature daffodil in Horticulture  
Sections E - F - G, class 146 seedling, Watrous

*Panel 2*

White Ribbon - Best vase of three stems of standard daffodils of one cultivar or species, Section B

*Panel 3*

Miniature White Ribbon - Best vase of three stems of miniature daffodils of one cultivar of species, Section F

*Panel 2*

Purple Ribbon - Best collection in Section C

Lavender Ribbon - Best collection in Section G

Maroon Ribbon - Best collection of five cultivars of daffodils, perianth colored - corona paler, any division or divisions, Section D, Class 121

Red-White-Blue Ribbon - Best collection of five cultivars of daffodils of American breeding or origin, any division or divisions, Section D, Class 122

Green Ribbon - Best collection of twelve cultivars of daffodils representing not less than four divisions, and/or species, Section D, Class 123

*Panel 1-2-3*

Rose Ribbon - Best standard daffodil seedling exhibited by its originator in any class in Horticulture

*Panel 1-2-3*

Miniature Rose Ribbon - Best seedling (miniature candidate) exhibited by its originator in any miniature class in Horticulture

Silver Ribbon - Most Blue Ribbons in all Horticulture

Roberta C. Watrous Award - Silver Medal or Ribbon for best collection in Section I, Class 147

Carey Quinn Award - Silver Medal or Ribbon for best collection in Section I, class 148

Throckmorton Ribbon - Best collection in Class 149

## Travel Directions from Columbus

Take U. S. 23 to near Chillicothe where you take Business 23 to U. S. 35. Turn right onto U. S. 35. Go to the first exit which is State Route 104.

Turn right onto 104 and go about 2 miles. Veterans Administration is on the left. Take first entrance and Building 9 is on the left.

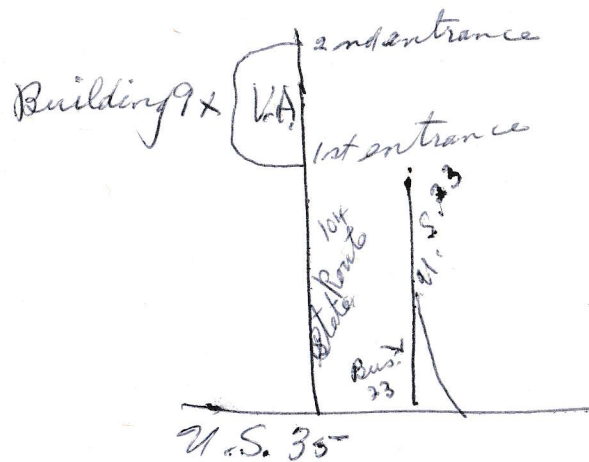

### Panel 1

Sec. A

Sec. H - Class 145

Sec. I - Class 148

Cristine Hanenkrat

Ruth Pardue

Marilyn Howe

### Panel 2

Sec. B, C, D

Sec. I - Class 149

Naomi Liggett

Doris Schuster

Grace Baird

### Panel 3

Sec. J and K

Sec. E, F, G

Sec. H - Class 146

Sec. I - Class 147

Leonora Wikie

Nancy Sill

Keg Newill

Dear Marilyn,

you are invited to a luncheon at 11:00 a.m. Judging begins at 12 noon.

we are so glad you can come to our show. I'll be going to Williamsburg, so I hope to meet you there.

See you Apr. 14th,

Ruth Junk

Judge's Chairman