

48th Annual Daffodil Show



Sponsored by
**South Western Ohio
 Daffodil Society**

An approved American Daffodil Society Show
 Midwest Regional Show

April 8 and 9, 2017
Krohn Conservatory, Eden Park,
Cincinnati, Ohio

Saturday, April 8 - Entries 7:30 to 10 AM
Judging (closed) 11 AM to 1 PM

Saturday, April 8 - Open to Public 1 AM to 5 PM
Sunday, May 1 - Open to Public 11 AM to 4 PM

American Daffodil Society Awards

- Gold Ribbon** Best Standard cultivar or species in the show
- White Ribbon** Best three stems of one cultivar
- Rose Ribbon** Best standard seedling exhibited by its originator
- Purple Ribbon** Best collection of 5 standards in show
- Red, White, & Blue Ribbon** Best collection from Class 16
- Maroon Ribbon** Best collection from Class 17
- Bozievich Award** Best Collection, 12 different standard blooms from at least four Divisions, Class 18
- Elise Havens Ribbon** Best collection from Class 19
- Tom Throckmorton Ribbon** Best collection from Class 20
- Carey Quinn Award** Best collection from Class 21 (Open only to ADS members.)
- Miniature Gold Ribbon** Best miniature bloom in Show
- Miniature White Ribbon** Best three stems from Classes 22 & 44
- Miniature Rose Ribbon** Best miniature seedling exhibited by its originator
- Lavender Ribbon** Best collection from Class 23
- Delia Bankhead Ribbon** Best collection from Class 24
- Roberta C. Watrous Award** Best collection from Class 25 (Open only to ADS Members.)
- Small Grower** Best stem in Class 34
- Silver** Awarded to exhibitor with most blue ribbons in show

Historic (pre 1940) Daffodil Ribbons, Best Historic Bloom in Show Ribbon Classes 36-38, Three stems of the same cultivar Class 37, and Collection of five different cultivars Class 38. Winners are eligible candidates for the **Gold, White and/or Purple Ribbons**.

Classic (1940 – 1969) Daffodil Awards, Best Single Bloom/stem in Classic Sections 39-41, Three stems of the same Classic cultivar for Class 40 and a collection of five Classic cultivars for Class 41. Winners are eligible candidates for the **Gold, White and/or Purple Ribbons**.

Intermediate Ribbons, best bloom from Classes 15-21 and 31-33 or Best Three Stems of the same cultivar Class 32 and for Best Collection of five cultivars Class 33. Winners are eligible for the **Gold, White and/or Purple Ribbons**

Youth Ribbon: Single Standard or Miniature stem exhibited by a person twenty years or younger, from Class 35.

HARRY I. TUGGLE, JR. AWARD Bronze Medal or Tuggle Ribbon: Best collection of three stems each of twelve different standard cultivars and / or species from at least three Divisions. Class 43

MINIATURE BRONZE RIBBON: Best collection of three stems each of five different miniature cultivars and/or species from at least three Divisions. (Any exhibit of three stems from this Class may compete for the Miniature White Ribbon) Class 44

GENERAL RULES

1. Entries may be made Saturday, April 8 from 7:30 A.M. to 10 A.M. All exhibitors must be off the floor by 10:00 A.M. THIS RULE WILL BE STRICTLY ENFORCED.
2. Entry cards for exhibits will be available at the show and may also be obtained in advance from the show chairman, Fredrica Lawlor, 513-473-8321. Do not fill in the bottom portion of card. Name stickers or rubber stamps are helpful.
3. **Entries, awards, and ribbons may not be removed until 4:00 P.M. Sunday.**

RULES FOR HORTICULTURAL EXHIBITS

ENTRIES

- All Classes are open to anyone who grows daffodils except where specified otherwise.
- Any information on an entry tag which could compromise the anonymity of the exhibitor must be concealed during judging.
- An exhibitor may make as many entries as desired in any Class provided each entry is a different cultivar or species or an entirely different collection of cultivars and/or species.
- All blooms in the Horticultural Division must have been grown in the open by the exhibitor. Miniatures and daffodils grown and shown in their containers may be grown in protected areas.
- Wedging material and containers for cut flower exhibits will be furnished by the show committee. Except for daffodils grown and shown in their containers, no daffodil foliage is permitted.
- All collections of five or more stems must be exhibited with each cultivar or species in a separate container.

LABELING

- Each cultivar or species must be correctly labeled with name and Division number. Originator's name must appear on the label in American bred Classes except seedlings shown by the originator. Note additional labeling requirements in schedule.
- Exhibits that are not named or incorrectly named will not be judged. Correct classification and labeling shall be the responsibility of the exhibitor.
- No label may be changed, specimen added, removed, altered, or substituted after judging has begun or after an award has been placed.

INTERMEDIATES, MINIATURES, AND SEEDLINGS

- An intermediate daffodil is a standard daffodil in Divisions 1, 2, 3, 4, 11, or 12 having a single floret whose diameter is typically between 1.5 and 3 inches. Intermediate daffodils may be entered in Classes for standard daffodils as well as Classes reserved for intermediate daffodils.
- Miniature daffodils may be shown only in Classes for miniatures. A miniature daffodil is any cultivar or species on the current ADS Approved List of Miniatures, with any official additions thereto. Also, any named or numbered daffodil which appears graceful, with all its parts proportionately small, may be exhibited in Miniature Classes and is eligible for all ADS awards, except that only numbered seedlings shown by the originator are eligible for the ADS Miniature Rose Ribbon. The judges may decline to judge any exhibit containing an unapproved miniature that they consider too large for these Classes.
- Blooms of seedlings may be exhibited in all Classes for named cultivars. **ALL SEEDLINGS MUST BE IDENTIFIED BY A NUMBER DESIGNATION ASSIGNED BY THE NUMBER DESIGNATION ASSIGNED BY THE ORIGINATOR.** If the exhibitor is not the originator, the name of the originator must be included as part of the identification.
- Each stem in an exhibit of cut flowers receiving an ADS Award must score 90 or more on the appropriate ADS Scale of Points.
- Only one first, one second, and one third award may be given in each class. Honorable mention awards may also be given if merited but only if first, second, and third have been awarded. First, second, third, and honorable mention awards may be withheld by the judges if in their opinion the exhibit is not worthy. If a blue ribbon (first place) has been awarded in a class eligible for an ADS ribbon, the ADS Award may not be withheld.
- Any report of an error shall be directed to the Show Chair, who will refer it to the panel of judges responsible for the award. If the judges are unavailable, the Show Chair shall make the final decision as to the validity of the reported error.
- The decision of the judges is final. If an error is discovered in an exhibit after completion of judging, any award placed thereon (ADS, Special, or Ribbon) shall be forfeited by the exhibitor. If an error is discovered before the judging is completed, the class must be rejudged.

MISCELLANEOUS

- The Show Committee reserves the right to subdivide classes by cultivar or color code when there are three or more worthy exhibits of the same cultivar or color code and if a sufficient number of worthy exhibits is left in the class. Species may be subdivided by their botanical sections.
- The Royal Horticultural Society System of Classification will be used. The labeling authority is Daffodils to Show and Grow as amended each year in the December ADS **Daffodil Journal** or ADS **Daffseek**.

SCHEDULE OF CLASSES

(Classes/Divisions may be subdivided per Rule 19)

Standard Daffodils

- Class 1** Division 1, Single stem standard bloom, Trumpet Daffodil Cultivars
Class 2 Division 2, Single stem standard bloom, Large Cupped Daffodil Cultivars
Class 3 Division 3, Single stem standard bloom, Short-cupped Daffodil Cultivars
Class 4 Division 4, Single stem standard bloom, Double Daffodil Cultivars
Class 5 Division 5, Single stem standard bloom, Triandrus Daffodil Cultivars
Class 6 Division 6, Single stem standard bloom, Cyclamineus Daffodil Cultivars
Class 7 Division 7, Single stem standard bloom, Jonquilla and Apodanthus D.C.
Class 8 Division 8, Single stem standard bloom, Tazetta Daffodil Cultivars
Class 9 Division 9, Single stem standard bloom, Poeticus Daffodil Cultivars
Class 10 Division 10, Single stem standard bloom, Bulbocodium Daffodil Cultivars
Class 11 Division 11, Single stem standard bloom, Split-Corona Daffodils Cultivars
Class 12 Division 12, Single stem standard bloom, Other Daffodil Cultivars
Class 13 Division 13, Single stem standard bloom, Daffodils distinguished solely by Botanical Name

Collections of Daffodils

- Class 14** **White Ribbon**, Three stems of the same standard bloom of any Division
Class 15 **Purple Ribbon**, Collection of 5 Standard blooms, all one Division
Class 16 **Red, White, & Blue**, American Collection, 5 different standard blooms, American bred, hybridizer's name appearing on each flower, also eligible for **Purple Ribbon**
Class 17 **Maroon Ribbon**, Collection, 5 different named reverse bicolor standard blooms, also eligible for **Purple ribbon**)
Class 18 **Bozievich Award**, Collection, 12 different standard blooms from at least four Divisions
Class 19 **Havens Award**, Collection, 12 different standard blooms, from at least three Divisions, limited to Divisions 5-10 only
Class 20 **Throckmorton Award**, 15 standard blooms with 15 different color codes
Class 21 **Quinn Award**, 24 different standard blooms, from at least five Divisions (Open to ADS members only.)

Miniature Daffodils

- Class 22** **Mini White Ribbon**, Three stems of the same miniature bloom of any Division
Class 23 **Lavender Ribbon**, 5 different miniature blooms
Class 24 **Delia Bankhead Ribbon**, 9 different miniature blooms from at least three Divisions
Class 25 **Watrous Award**, 12 different miniature blooms from at least three Divisions (Open to ADS members only.)
Class 26 Single stem miniature bloom from Division 1 or 2
Class 27 Single stem miniature bloom from Division 3 or 4
Class 28 Single stem miniature bloom from Division 5 or 6
Class 29 Single stem miniature bloom from Division 7 or 8
Class 30 Single stem miniature bloom from Division 9 -13

Intermediate Daffodils

- Class 31** Single Stem Division 1 - 4, or 11 Best Single stem in 31-33
Class 32 Three stems Division 1 - 4 or 11, also Eligible for **White Ribbon**
Class 33 Five stems intermediate cultivars, also Eligible for **Purple Ribbon**
** 31-33 also eligible for **Gold Ribbon***

Small Growers

- Class 34** **Small Growers Ribbon** Single Stem of standard or miniature daffodil, any division, open to growers of fifty or less daffodils

Youth Ribbon (Any exhibitor 20 years or younger)

Class 35 Single stem of Standard, Miniature and/or Species

Historics—Pre 1940

Class 36 Single stem standard historic cultivar

Class 37 Three stems standard historic cultivar, also Eligible for **White Ribbon**

Class 38 Collection of five standard historic cultivars, also Eligible for the **Purple Ribbon**

**Best stem from 36-37 Eligible for Gold*

Classics—1940 -1969

Class 39 Single Stem Classic

Class 40 Three stems Classic also eligible for **White Ribbon**

Class 41 Collection of five Classic stems and Eligible for the **Purple Ribbon**

**Best stem from 39-41 Eligible for Gold*

SPECIAL AWARDS

Class 42 Single stem bred in New Zealand (originator's name must be on entry card) Special award sponsored by **M.E. (Spud) Brogden**.

Class 43 HARRY I. TUGGLE, JR. AWARD Bronze, Medal or Tuggle Ribbon - Best collection of three stems each of twelve different standard cultivars and/or species from at least three Divisions, (any exhibit of three stems may compete for the **White Ribbon**)

Class 44 MINIATURE BRONZE RIBBON - Best collection of three stems each of five different miniature cultivars and / or species from at least three Division, (any exhibit of three stems may compete for the **Miniature White Ribbon**)

Class 45 CHAIRMAN'S AWARD – Best Division 11 Cultivar

Directions to Krohn Conservatory - <http://www.cincinnatiiparks.com/krohn-conservatory/>

1501 Eden Park Drive, Cincinnati, Ohio 45202 – 513-421-4086

The show will be staged in a tent in front of the Show House Entrance.

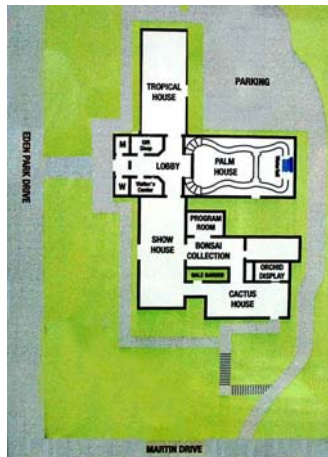

2017 SHOW COMMITTEE

Chair Fredrica Lawlor

Schedule Kim Henninger & Linda Wallpe

Classification & Placement Margaret Baird

Judges Mary Lou Gripshover

Clerks George McGowan

Recorder Rebecca Koesters

Hospitality Susan Ruoff

Staging & Properties George McGowan

Setup/Strike SWODS Members

Program Schedule Cover Art Suzy Wert

JOIN NOW

Southern Ohio Daffodil Society (SWODS) - SWODS membership: \$5 per year

Membership Benefits

- An annual show of daffodils each spring, which is both an exhibit for the public and a friendly competition for members, visitors, and the general public.
- Opportunity to purchase a special Challenge Bulb for members at less than catalog price.
- Exhibits in public areas and speeches, slide show presentations, and workshops at garden society meetings and public gardening events.
- Annual bulb exchange for members at the fall meeting; an opportunity to acquire new daffodils at the best possible price – free!
- Camaraderie with other daffodil growers.

Send \$5.00 Dues to Susan Ruoff, 7194 Orchardview, Morrow Ohio 45152

SRMorrow@roadrunner.com, 513-515-6745

American Daffodil Society (ADS) - ADS membership: \$30 year or \$75 for 3 years

Website www.daffodilusa.org

- Subscription to the Daffodil Journal, a 64 page quarterly journal with color photographs of daffodils and articles on topics such as planting, selecting, and growing daffodils; landscaping with daffodils, new introductions, hybridizing, daffodil hybridizers, trends, pests and diseases, and national and local news and events.
- Participation in national daffodil events.
- Catalogs from daffodil specialty grower.
- Eligibility to compete for ADS awards in local, state, and national shows.

Send dues to Edie Godfrey, Executive Director, 21498 Crahan Lane, Belle Plaine, MN. 56011, 952-873-4522 <mailto:ediegodfrey@frontiernet.net>